

244329

P-116-0109
Building

CITY OF NAPOLEON GENERAL PERMIT APPLICATION

THIS APPLICATION IS FOR RESIDENTIAL CONSTRUCTION INCLUDING BUILDING, ELECTRICAL, PLUMBING, MECHANICAL & REMODELING

DATE 4-14-16 JOB LOCATION 406 Appian Ave
OWNER Mark Myers TELEPHONE # _____
OWNER ADDRESS 406 Appian Ave Napoleon, OH 43545
CONTRACTOR Hanson's Windows & Siding CELL PHONE # (248) 581-3630
x3200

DESCRIPTION OF WORK TO BE PERFORMED _____
Strip and re-roof (house only)
ESTIMATED COMPLETION DATE _____ ESTIMATED COST \$7,442.00

Affected Floor Area (AFA): In existing structures, it is the area affected by the improvement, i.e. a new wall dividing a room (the AFA would be only the room and not all the rooms).

DESCRIPTION	FEE	TOTAL COST
BUILDING:		
Decks	\$25.00	\$
Addition & Alterations Square foot in (AFA) _____ x \$0.05 = \$ _____ +	\$25.00 =	\$
Garage and Shed over 200 SF (Detached)	\$25.00	\$
Siding and/or Roofing	\$25.00	\$ <u>25.25</u>
Windows/Doors	\$25.00	\$
ELECTRICAL:		
Electrical Circuits in (AFA) _____ x \$3.00/Circuit = \$ _____ +	\$25.00 =	\$
Electrical Service Upgrade	\$25.00	\$
MECHANICAL:		
Water Heater	\$25.00	\$
Furnace and/or AC Replacement	\$25.00	\$
PLUMBING:		
Plumbing Traps in (AFA) _____ x \$3.00/Trap = \$ _____ +	\$25.00 =	\$
TOTAL plus Ohio Board of Building Standards Fee 1% \$		

TOTAL FEE: \$ 25.25

I FULLY UNDERSTAND THAT NO EXCAVATION, CONSTRUCTION OR STRUCTURAL ALTERATION, ELECTRICAL OR MECHANICAL INSTALLATION OR ALTERATION OF ANY BUILDING STRUCTURE, SIGN, OR PART THEREOF AND NO USE OF THE ABOVE SHALL BE UNDERTAKEN OR PERFORMED UNTIL THE PERMIT APPLIED FOR HEREIN HAS BEEN APPROVED AND ISSUED BY THE CITY OF NAPOLEON BUILDING/ZONING DEPARTMENT.

I hereby certify that I am the Owner of the named property, or that the proposed work is authorized by the Owner of record and that I have been authorized by the Owner to make this application as his/her authorized agent and I agree to conform to all applicable laws of the jurisdiction. In addition, if a permit for Work described in this application is issued, I certify that the code official or the code official's authorized representative shall have the authority to enter areas covered by such permit at any reasonable hour to enforce the provisions of the code(s) applicable to such permit.

I HEREBY ACKNOWLEDGE THAT I HAVE READ AND FULLY UNDERSTAND THE ABOVE LISTED INSTRUCTIONS.

SIGNATURE OF APPLICANT: Brian Elias DATE: 4-14-16

PRINT NAME: Brian Elias

PERMIT # _____ BATCH # 34090 CHECK # 22870 DATE 4/18/16



HOMES IMPROVEMENT INSTALLMENT CONTRACT AND AGREEMENT
 The customer(s) ("Owner(s)") listed below jointly and severally agree to purchase the goods and/or services listed below, in accordance with the prices and terms described on the front and reverse of this agreement ("Agreement") and all attached Specification Sheets, and Owner(s) has requested that such goods and/or services be installed or provided at Owner's address listed below. Hanson Windows and Construction, Inc. ("Contractor") hereby agrees to install or cause to be installed, the products or services listed in this Agreement. Owner(s) agrees to sign a completion certificate upon completion of the installation of the goods. This agreement represents a cash sale of good and/or services. Owner(s) agrees to pay in cash the cost of the goods and/or services purchased as described below, with full payment due upon substantial completion of the job, regardless of timing or approval of any financing Owner(s) may seek for the purchase.

WD196 244329

MEASURE DATE	MEASURE TIME	WITHIN THE WANT GUARANTEE-INSTALL TO BE COMPLETED IN APPROXIMATELY	Page 1 of 2
4-12	3pm	6 to 12 weeks after approval	1575858

Appointment Number

Gift Promo This Month? YES NO WAIVE Cust. Initials: RLM

CUSTOMER INFORMATION

Customer Last Name: Myers

Home Phone Number: None

Address where work is to be done: 406 Appian Ave
Napoleon OH 43545

Who do you pay your taxes to? (For permit applications) Napoleon

Billing Address: Same As Above

Mr. First Name: Mark

Text OK YES NO Mr. Cell: 419-9166-9958

Mr. Work #: Can't Receive

Mr. Email: Myers.mark.danise@Hptm

Mrs./Ms. First Name: Rose

Text OK YES NO Mrs. Cell: 419-591-9564

Mrs. Work #: Can't Receive

Mrs. Email: Use use Mrs email

HOME INFORMATION

TYPE OF HOME: House Condo MHC

Historical District: Yes No Year Built: 1960

Work To Be Done: House Garage Home/Garage Attached

FULL JOB PARTIAL JOB

If Condo, Name of Complex: _____ Ph# _____

CUSTOMER AGREES TO TERMS OF PAYMENT AS FOLLOWS:

Spec sheet total (Includes promotion\$ 2542 and all advertised discounts)	\$ 9984
Amount of wood prepaid, if applicable (If not, see spec sheet)	\$ 0
Administration Fee	\$ 295.00
FINAL TOTAL	\$ 7442
Deposit amount (50% required)	\$ 2455
Balance to be paid upon substantial completion	\$ 4987
Amount financed	\$ 0

DEPOSIT/FINAL PAYMENT IN THE FORM OF:

CASH CHECK # 1215 VISA Master Card

Name on Credit Card: _____

Credit Card #: _____

Exp. Date _____ CPU Code: _____

Your final check is your receipt

BUYERS RIGHT TO CANCEL: You, the Buyer(s), may cancel this transaction at any time prior to midnight of the third business day after the date of this transaction. See the accompanying Notice of Cancellation form for an explanation of this right. Additionally, the seller is prohibited from having an independent courier service or other third party pick up your payment at your residence before the end of the 3-business-day period in which you can cancel the transaction.

IN WITNESS WHEREOF the parties have here unto signed their name(s) this 4th day of April, 2016

MICHIGAN/OHIO SOLICITATION SALES ACT
 disclosure cut off date: 5th day of April, 2016

Owner(s) agrees that this Agreement, front and reverse, constitutes the entire understanding between the parties, and there are no verbal understandings changing or modifying any of the terms of this agreement. This Agreement may not be changed or Owner(s) hereby acknowledges that Owner(s) has read the front and reverse of this Agreement and has received a completed, signed and dated copy of this Agreement, including the two accompanying Notice of Cancellation forms, on the date first written above. Owner(s) also acknowledges that he or she was orally informed of his or her right to cancel this transaction.

Owner: Mark Myers

Owner: Mark Myers

SALESPERSON (Please Print Name): Jimmy Alton LOCATION: Hansons Windows of Toledo, OH 7202

JUST THE FACTS	
1 Rm	First of all... No verbal agreements are recognized. Everything must be in writing on the contract. Please make sure everything is written on your order. If something is not on your work order, please do not request it from our staff. They are not allowed to give anything not on the contract.
2 Lm	Permits: We will obtain all jobs where they are required. Your permit cost is in addition to your contract price. It may be advised for us to add a standard permit charge to all contracts, which prices vary greatly from one city and using codes do not engage permits. It is responsible for your representative to determine your permit cost. (usually between \$50 and \$300). We will charge what the city charges us, not a penny more. Certain cities require final inspections. It is your responsibility to be home for your scheduled inspections.
3 Rm	Method used is beyond our control. We don't know what to remove your chimney, your existing siding or windows. Wood replacement is necessary in about 1/3 of all jobs. If we find rotted wood on or in stumps or trim or cut up to code, there will be additional charges for replacing it. If your contract is finished, we will automatically add this amount to your loan. You will be required to sign new documents.
4 Rm	Condominiums... Customers are responsible for obtaining their own condo approvals. All associations have their own rules. Normally, approvals are granted when replacing like products and colors.
5 Rm	Contact info... We require at least 2 telephone numbers and an email address from every customer. Please provide this information and the best numbers to contact you during working hours (9AM-5PM)
6 Rm	Project Managers... You will be assigned your own project manager. The main extension for the installation department is 3600. Your project manager will call you the morning of your installation and let you know what time your installer is expected to arrive within a 2 hour time frame; for example 9-11AM, but it does vary depending on drive times and material pick up.
7 Rm	Installation start time is approximately 6 to 12 weeks after approval. Please refer to the installation time frame on your contract. Sales reps are not allowed to change these times. You may not hear from us for a period of time while we are waiting for your materials to arrive. Don't worry!! We will call as soon as possible to schedule your job. If you are using our financing, the clock will start ticking until your loan is approved. If your installation time extends past the estimated time on your contract, we will credit your account \$50 per week for every week that we fall behind.
8 Rm	We cannot hold or guarantee any installation dates. Installations are weather pending and nobody can predict Mother Nature. Our installers use power tools, so we use weather reports as a guide. Keep in mind, it may not be raining at your house, but it may be expected in your area. Sometimes crews call in sick, trucks break down, etc., just like every other place of business. Please be understanding if this happens. If by chance, your installation is cancelled more than once, for reasons other than weather, we will gladly refund \$100 to you for your inconvenience.
9 Rm	If you MUST have a Saturday, your projected time of installation may be longer than what is written on the contract. Special order items may also add to the time frame. All installation arrival times are based on 2 hour increments, such as 8-10, 9-11, 10-12. We cannot pinpoint an exact arrival time.
10 Rm	Length of Installation - Average time for a roofing installation is 2 - 5 days. Siding installations are 3 - 10 days. These time frames are based on the size of the jobs and the degree of difficulty so longer installation times may occur.
11 Rm	A responsible adult 18 years or older must be at the installation site at the beginning and the end of the job. The head installer will do a walk around with you prior to starting work to assess any existing damage, landscaping, or any property that could be affected by the construction. He is available to answer any questions you may have at that time. The head installer is also required to do a post inspection when the job is completed. We want to make sure that we exceeded your expectations, so go over the job very carefully. If there is anything that needs to be addressed, he will be able to take care of it, or ensure that any necessary parts are re-ordered. Your balance due is payable by cash, check, money order, or credit card. If you are using our financing program a completion slip may need to be signed. Your installer will need to collect at the end of the job.
12 Rm	Installation Team... We only use Hanson's-authorized contractors. Crews usually consist of 1 to 4 people. Our installer-partners use their own trucks and tools and are fully insured over and above Hanson's existing please take down all decorations hanging on the walls.
13 Rm	Power... Installers will need to use your electricity. They do not carry generators, so I agree to supply access to my power.
14 Rm	Children and pets... Please provide a safe location away from the area during the installation process. Installers use power tools and we don't want anyone to get hurt.
15 Rm	Financing... If you are financing your balance, Hanson's finance department will notify you when your loan is approved. This could take up to 14 days. We will work hard with the finance companies to get your loan approved and sometimes the terms will change. The finance company may also ask you for additional information and your cooperation will help speed the process. If any loan terms change, Hanson's finance department and/or your representative will explain them to you.
16 Rm	Landscaping... When your installation is in process, there is debris. Some of it could fall on your landscaping. Our installers do their best to avoid damaging your flowers, trees, and bushes, but sometimes it does happen. Please be understanding.
Roof / Siding / Gutters:	
17 Rm	Dumpster... Under no circumstances do we leave debris on your property. We remove everything for safety reasons. Please don't ask our sales reps or our installers if you can keep the scrap. Dumpsters are not for customer use.
18 Rm	Roof Installation... If your roof is leaking, we will prioritize it to the best of our ability. We will be doing a lot of banging up there, so you should expect debris in your attic. Make sure your valuables are protected with tarps. We will remove and reinstall your satellite dishes but we can't see the satellite so you will have to call your provider to have it lined up. Please cover all A/C units prior to installation.
19 Rm	Shingles are delivered to your roof top. There are a lot of bundles and it is very difficult to carry them up a ladder. You will be asked to sign a waiver so that the delivery truck can pull into your driveway. A dumpster will be delivered early in the morning on the day of your scheduled installation. It will also be in your driveway. Please make sure that your vehicles are out of the way and accessible to you. We don't like to trap our customers in their own garage, they get mad. Generally, the dumpster is picked up 24 to 48 hours after completion.
20 Rm	Gutters... Will not have extensions unless on the work order, they are an additional charge. Per code, most cities do not allow downspouts to go into cracks. Gutter installers will determine the most efficient downspout placement. They will be happy to work with you if you have any special requests. Gutter protection products can increase the formation of icicles. This is a normal occurrence.
Windows / Doors:	

ALL CONTRACTS

Rm I understand the details of my pre-install checklist and I have received a copy. Please start my order immediately. If I do not answer your call within 24 hours please feel free to call my manager at extension # 1111

LEAD SAFE PAINT PRACTICES

Rm LEAD SAFE PAINT PRACTICES I/we hereby acknowledge receipt of a copy of the pamphlet, "Renovate Right: Important Lead Hazard Information for families, child care providers and schools", informing me/us of the potential risk of lead hazard exposure from renovation activity to be performed in my/our home. I/we received this pamphlet before the work began.

Customer elects reduced warranty option for a term of 1/2 years.

244389

LAST NAME
Myers

APPOINTMENT ID
1575358

Page 2 of 2

LOCATION
 HOME
 GARAGE
 BOTH
 HOME/GARAGE ATTACHED
 FULL JOB
 PARTIAL JOB

COLORS

Single Color: Heathstone Grey
 Drip Edge Color: White
 Black
 Clay
 Wicker
 Brown

Flat Roof Color: 2

Flat Roof # of Squares: 2

Exclusive low-slope self-adhering roofing system, 12 Year Guarantee (limited under 27.2 pitch). Must sign low-slope roof waiver if applicable.

OF LAYERS
 1 Layer
 2 Layer
 3 Layer

VENTILATION
 Ridge
 Cans

PITCH 8/12 or greater

FULL ICE & WATER SHIELD PER CODE (required from 2/12 to 3.99/12 pitch)
 # of squares 2
 # of skylights 0
 Labor Only 2
 (Customer must supply skylights)

X Roof repair
 X Make G. Myers

STANDARD

Hybrid Dimensional shingle with SBS Technology and Scotchguard Protector. 4 1/2 feel ice and water shield, 15 lb. felt paper, 150 cfm vents, intake ventilation as needed, US 25 year warranty capmaster, 15 year warranty
 # OF SQUARES 13.9

PERFORMANCE

Hybrid Dimensional shingle with SBS Technology and Scotchguard Protector. 4 1/2 feel ice and water shield, 30 lb. felt, intake ventilation as needed, new drip edge, 150 cfm vents, capmaster, 25 year warranty
 # OF SQUARES 13.9

SMART CHOICE

Hybrid Dimensional shingle with SBS Technology and Scotchguard Protector. 6 feel ice and water shield, hansonsguard, choice of 750 can vents or ridge vent, intake ventilation as needed, new drip edge, capmaster, lifetime guarantee
 # OF SQUARES 13.9

PREMIUM

Metal shingle, 6 feel ice and water shield, intake ventilation as needed, hansonsguard, choice of 750 can vents, ridge vent, new drip edge, capmaster, lifetime guarantee
 # OF SQUARES 13.9

AVAILABLE SHINGLE COLORS

- Black Shadow
- Burnt Sienna
- Desert Shake
- Heathstone Gray
- Heatherblend
- Highland Brown
- Majestic Shake
- Pewter
- Weathered Wood
- FLINTLASTIC
- Burnt Sienna
- Colonial Slate
- Heather Blend
- Moire Black
- Resawn Shake
- Weathered Wood
- White

DRAWING OF HOME

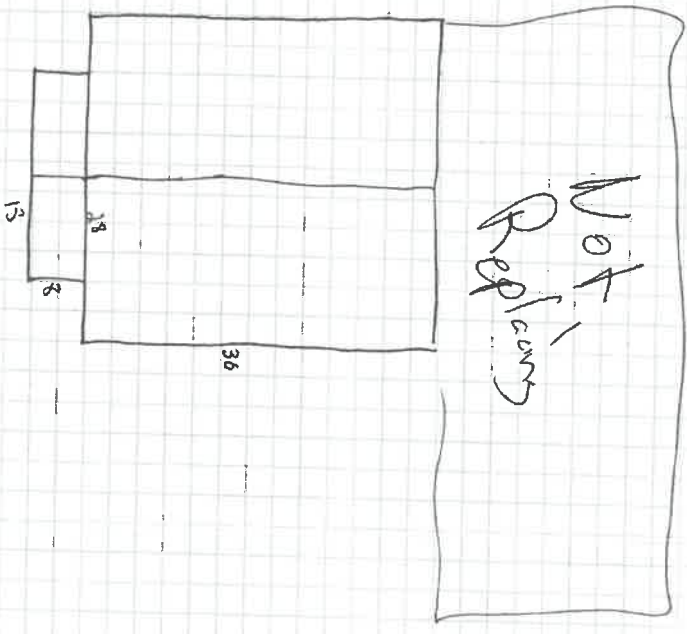

This specification sheet must be accompanied by a separate wood agreement form. I acknowledge that I did sign the wood agreement form.
 Wood Form Properly Filled Out Yes

Only replacing main roof and front porch

